

Transportation to participate in the 16th International Conference on Environmental and Rural Development (ICERD)

Tokyo, Japan, 13-16 March 2025

1. From recommended hotels to Tokyo University of Agriculture

No.	Route	Time	Price (JPY)
1 (the b sangenjaya)	<p>Sangenjaya Station (Stn) - Nodai Front. Tokyu Bus</p> <p>1. For Yoga Stn #22 Bus</p> <p>2. For Soshigaya Ohkura Stn #23 Bus</p> <p>3. For Seijyogakuen Stn #24 Bus</p> <p>Tokyo University of Agriculture is a 1-minute walk from the Nodai Front bus stop.</p>	15 min.	230
2 (Tokyu Stay Yoga)	<p>Yoga Stn- Nodai Front. Tokyu Bus</p> <p>For Shibuya Stn #22 Bus</p>	12 min.	230
3,4 (Sakura Fleur Aoyama, Shibuya Tobu Hotel)	<p>Shibuya Stn - Nodai Front. Tokyu Bus</p> <p>1. For Yoga Stn #22 Bus</p> <p>2. For Soshigaya Ohkura Stn #23 Bus</p> <p>3. For Seijogakuen Stn #24 Bus</p>	30 min.	230

Tokyu Bus Shibuya Stn, Sangenjaya Stn and Yoga Stn Bus Stop Map/Route/Time Table:

[Shibuya Sta. Bus stop map | Tokyu Bus \(navitime.biz\)](#)

[Sangen-jaya Bus stop map | Tokyu Bus \(navitime.biz\)](#)

[Yoga Sta. Bus stop map | Tokyu Bus \(navitime.biz\)](#)

2. From Shinjuku Stn to Tokyo University of Agriculture

No.	Route	Time	Price (JPY)
1	Shinjuku Stn – Kyodo Stn. Odakyu Line The third station by express train. Tokyo University of Agriculture is 15 minutes' walk from Kyodo Stn.	30 min.	200

Odakyu line Shinjuku Stn Time Table:

<https://www.odakyu.jp/english/transport/timetable/>

Tokyo University of Agriculture Setagaya Campus Access:

<https://www.nodai.ac.jp/english/access/setagaya/>

From Haneda Airport to Tokyo University of Agriculture

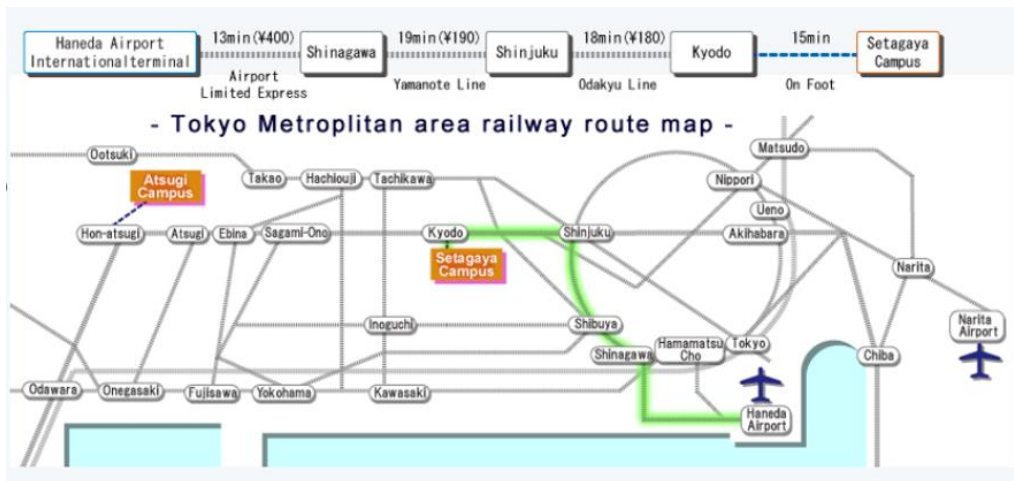

From Narita Airport to Tokyo University of Agriculture

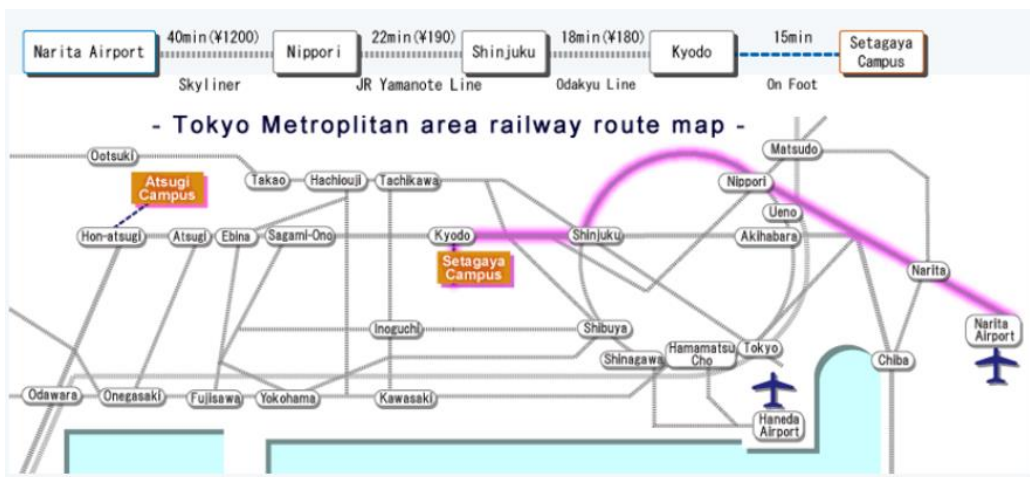

From Kyodo Stn, Chitosefunabashi Stn to Tokyo University of Agriculture

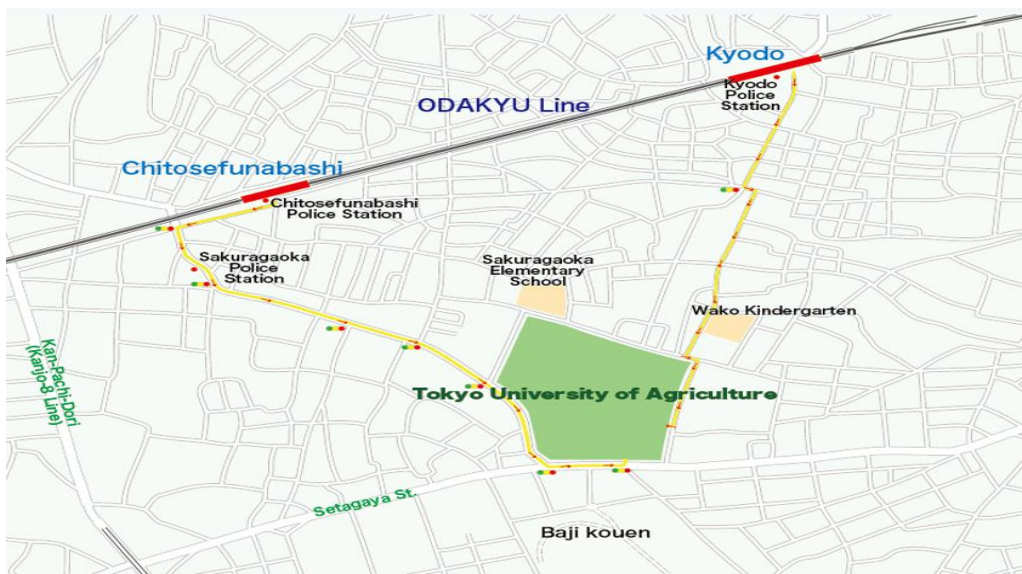

Recommended hotels to Tokyo University of Agriculture Access Map

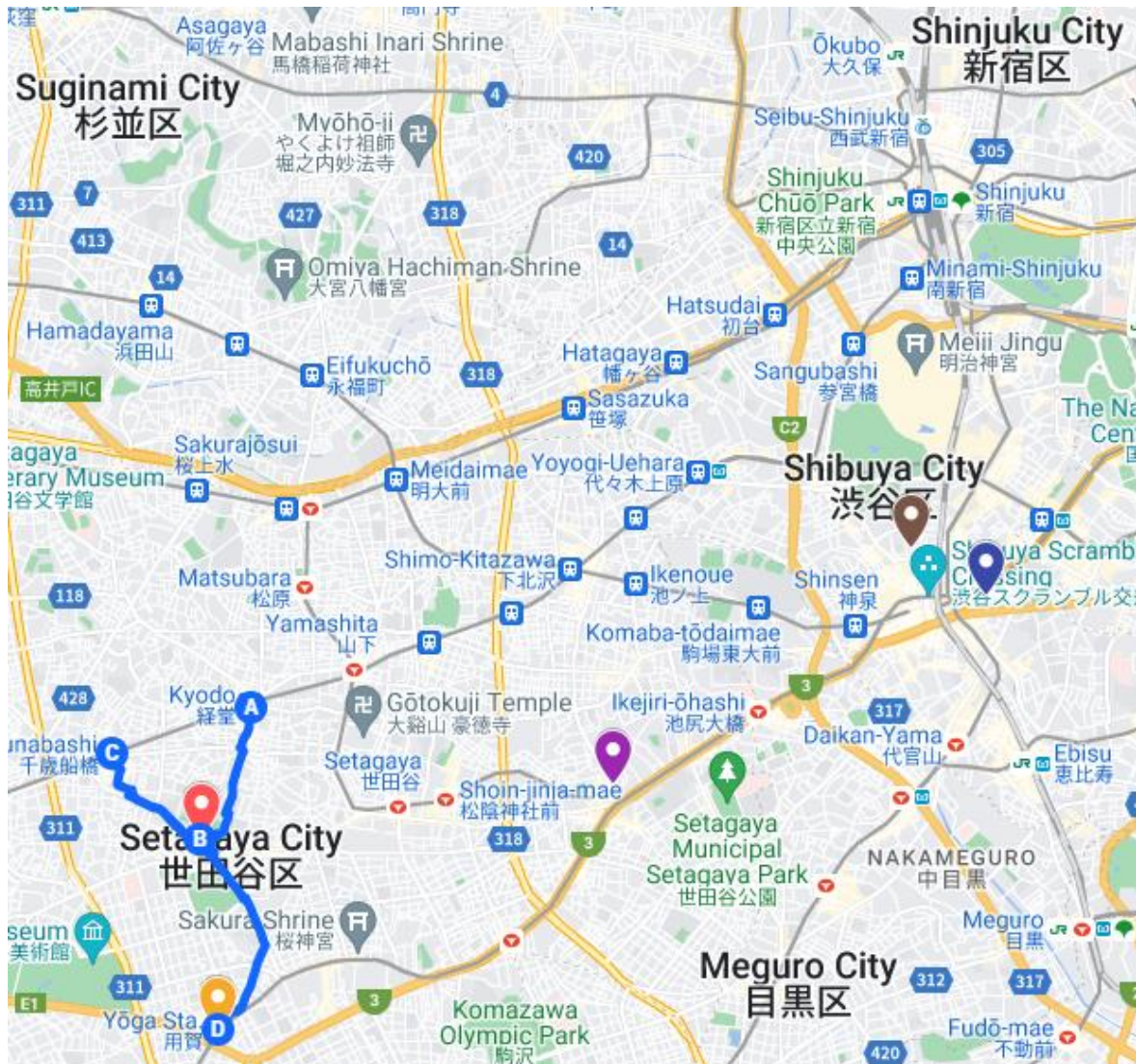

- 📍 Tokyo University of Agriculture
- 📍 Tokyu Stay Yōga
- 📍 the b sangenjaya
- 📍 Sakura Fleur Aoyama
- 📍 Shibuya Tobu Hotel

- A Kyodo Station, 2 Chome-1 Ky...
- B Tokyo University of Agriculture
- C Chitose-Funabashi Station, 1...
- D Yōga Station, 2 Chome-39 Yo...

<https://www.google.com/maps/d/edit?mid=1G->

[BVP901dSlhv1YO1fJpfcJ2ZippjBQ&ll=35.64186622402875%2C139.65923137860267&z=14](https://www.google.com/maps/d/edit?mid=1G-BVP901dSlhv1YO1fJpfcJ2ZippjBQ&ll=35.64186622402875%2C139.65923137860267&z=14)

Tokyo University of Agriculture Campus Map

Open Hour
 Cafeteria Suzushiro
 Lunch hour 11:00-14:00

NODAI CO-OP
 Open 10:30-15:00

7-Eleven
 Open 8:00-18:00(July22-Aug6) except for Sun.

Campus Map

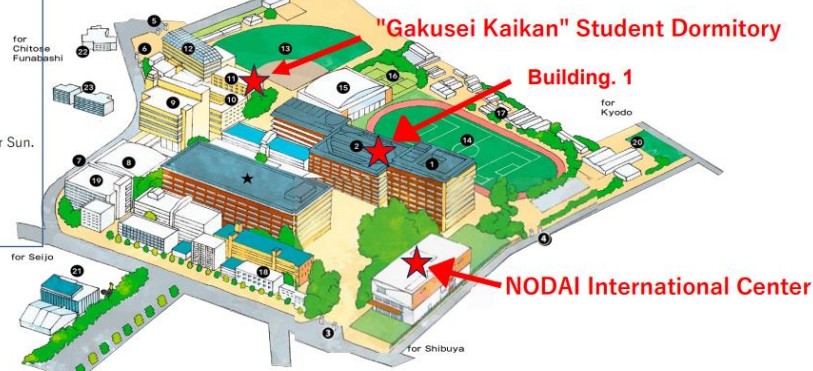

You can withdraw JPY from ATMs at 7-Eleven



- ★ NODAI Science Port (Research Laboratories Building)
- ★ NODAI Academia Center (Main Library, Administration and University Offices) Admissions center on 1st floor.
- ★ Bidg. 1 (Lecture Halls)
- ★ Main Gate
- ★ Kyodo Gate
- ★ Chitose Gate
- ★ Sakuragaoka Gate
- ★ Youga Gate
- ★ Centennial Hall Cafeteria "Green"
- ★ Bldg. 18 Cafeteria "Suzushiro"
- ★ Tokiwamatsu Student Main Hall (Alumni Rooms, NODAI CO-OP, 7-Eleven)
- ★ Tokiwamatsu Student Hall (Club Rooms)
- ★ Tokiwamatsu Hall Dojo
- ★ Baseball Field
- ★ Athletic Field
- ★ Sakuragaoka Arena (Gymnasium, Training Room)
- ★ Tennis Courts
- ★ Greenhouses
- ★ Bidg. 16 (Health and Wellness Center)
- ★ Bidg. 12 (Food Processing Center)
- ★ Hockey Field
- ★ Food and Agriculture Museum - Biorium-Cafe "egg"
- ★ Green Academy Hall (Life long Education)
- ★ Sakuragaoka Dormitory, Wakakusa Dormitory

NODAI International Center Floor Map

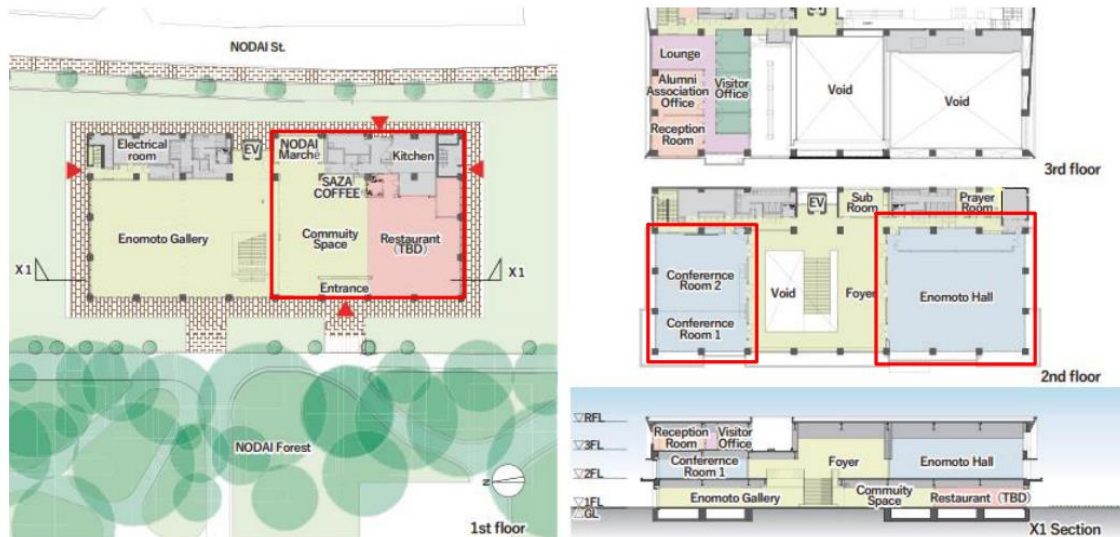

The area highlighted by th red border is the main venue for the 16th ICERD.